

Safety switch with separate actuator

ST 14

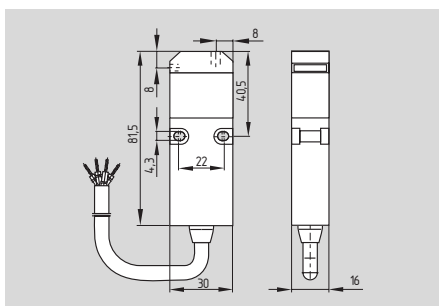

- Thermoplastic enclosure
- Slim design
- Multiple coding
- Long life
- Double insulated
- High level of contact reliability with low voltages and currents
- With pre-wired cable
- Actuator with rubber mounting
- EEx version available

Technical data

Standards: IEC/EN 60947-5-1
BG-GS-ET-15

Enclosure: glass-fibre reinforced thermoplastic, self-extinguishing

Actuator: stainless steel 1.4301

Protection class: IP 67 to EN 60529

Contact material: silver

Contact type: change-over contact with double break, type Zb or 2 NC contacts

Switching system: \ominus IEC 60947-5-1 slow action, NC contact with positive break

Connection: pre-wired cable 4x AW 620, UL 2464, 1 m, 2 m, 5 m or 10 m long

Cable section: 4 x 0.56 mm²

U_{imp}: 4 kV

U_i: 250 V

I_{the}: 6 A

Utilisation category: AC-15, DC-13

I_e/U_e: 6 A / 250 VAC
4 A / 24 VDC

Max. fuse rating: 6 A gG D-fuse

Positive break travel: 8 mm

Ambient temperature: - 20 °C ... + 80 °C

Mechanical life: > 1 million operations

Contact variants

1 NO / 1 NC

RD 11 → 12 OG
BK 23 → 24 BN

2 NC

RD 11 → 12 OG
BK 21 → 22 BN

Approvals



Ordering details

ST 14 ①-②-③-④

No.	Replace	Description
①	1Ö/1S 2Ö	1 NO / 1 NC 2 NC
②	s	Cable output bottom Cable output lateral
③	2m 5m 10m	Cable length 1 m Cable length 2 m Cable length 5 m Cable length 10 m
④	Gold	Gold-plated contacts

Note

Actuators must be ordered separately.

Safety switch with separate actuator

System components

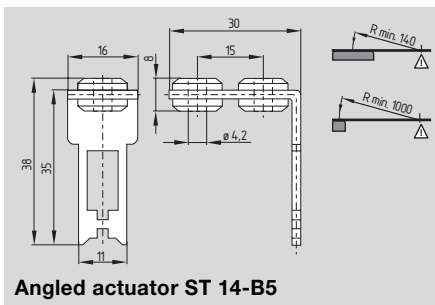
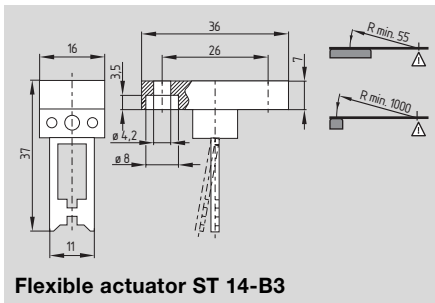
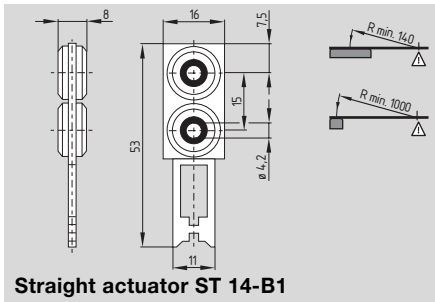

Ordering details

Straight actuator:	ST 14-B1
Self-locating actuator:	ST 14-B3
Angled actuator:	ST 14-B5

Safety switch with separate actuator

AZ 17

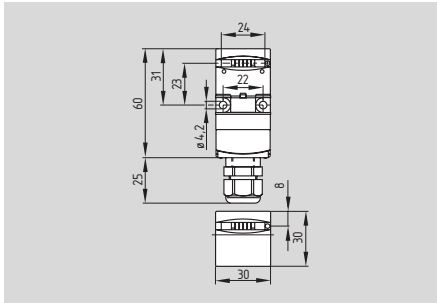

- Thermoplastic enclosure
- Small body
- Multiple coding
- Individual coding available on request
- Long life
- Double insulated □
- Including cable gland M16
- Slot sealing plug included
- High level of contact reliability with low voltages and currents
- Not sensitive to dirty conditions by virtue of patented roller system
- 8 actuating planes
- Insulation displacement connector

Technical data

Standards: IEC/EN 60947-5-1
BG-GS-ET-15

Enclosure: glass-fibre reinforced thermoplastic, self-extinguishing

Actuator: stainless steel 1.4301

Protection class: IP 67 to EN 60529

Contact material: silver

Contact type: change-over contact with double break, type Zb or 2 NC contacts, with galvanically separated contact bridges

Switching system: ⊖ IEC 60947-5-1 slow action, NC contact with positive break

Connection: cut clamp terminals (IDC method)

Cable section: 0.75 – 1.0 mm², flexible

U_{imp}: 4 kV

U_i: 250 V

I_{th}: 10 A

Utilisation category: AC-15

I_e/U_e: 4 A / 230 VAC

Max. fuse rating: 6 A gG D-fuse

Positive break travel: 11 mm

Positive break force: 17 N for each NC contact fitted

Ambient temperature: – 30 °C ... + 80 °C

Mechanical life: > 1 million operations

Latching force: 30 N for ordering suffix r

Contact variants

1 NO / 1 NC

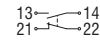

2 NC

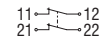

Connector

1 NO / 1 NC

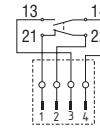

2 NC

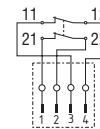

Front cable output

1 NO / 1 NC

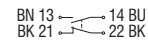

2 NC

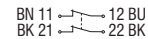

Rear cable output

1 NO / 1 NC

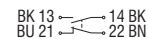

2 NC



Approvals



Ordering details

AZ 17-①z②k-③-④-⑤

No.	Replace	Description
①	11 02	1 NO / 1 NC 2 NC
②	r	Latching force 5 N Latching force 30 N
③	2243	Cable gland M16 Cable output front
	2243-1	rear
	ST	Connector M12
④	1637	Gold-plated contacts
⑤	5m 6m	Cable length 5 m Cable length 6 m

Note

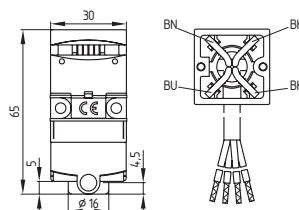

- Front cable output, ordering suffix -2243
- Rear cable output, ordering suffix -2243-1

Note

Actuators must be ordered separately.

Safety switch with separate actuator

System components

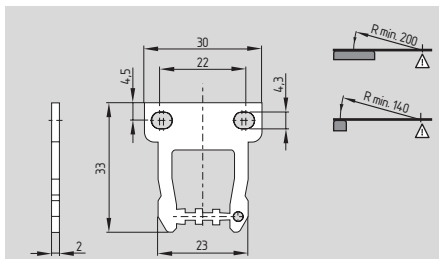

Straight actuator AZ 17/170-B1

System components

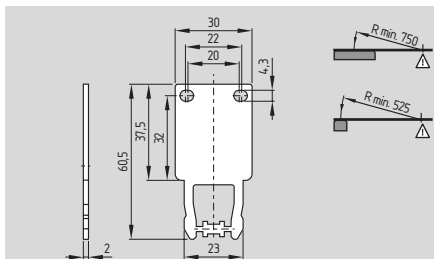

Long straight actuator AZ 17/170-B11

System components

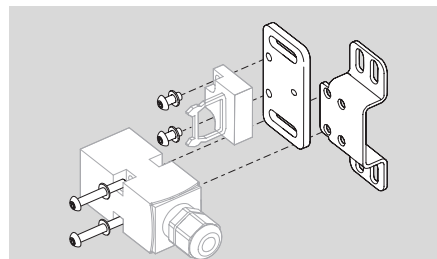

Mounting set MS AZ 17

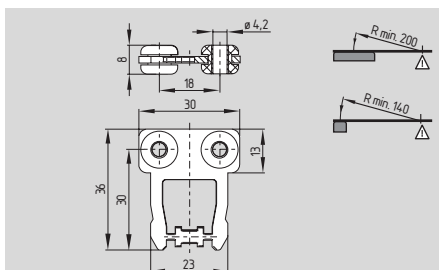

With rubber mounting AZ 17/170-B1-2245

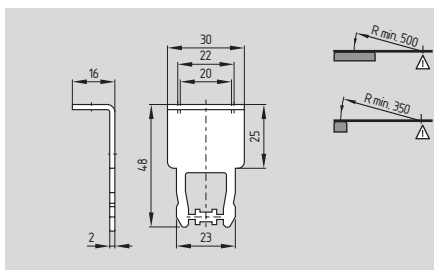

Long angled actuator AZ 17/170-B15



Connector plug M 12 x 1

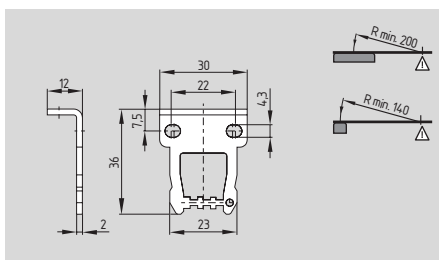

Angled actuator AZ 17/170-B5



Connector plug M 12 x 1 (with cable)

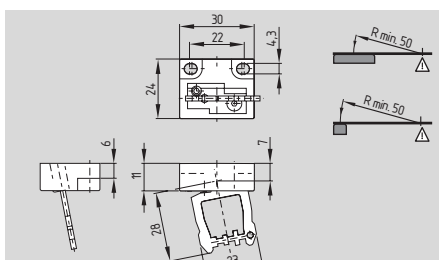

Flexible actuator AZ 17-B6



Tamperproof screws

Ordering details

Straight actuator **AZ 17/170-B1**
 with rubber mounting **AZ 17/170-B1-2245**
 Angled actuator **AZ 17/170-B5**
 Flexible actuator **AZ 17-B6**

Ordering details

Long straight actuator **AZ 17/170-B11**
 Long angled actuator **AZ 17/170-B15**

Ordering details

Mounting set **MS AZ 17**
 Connector plug M 12 x 1 **1093038**
 Connector plug M 12 x 1 (with cable) **1148412**
 Tamperproof screws with unidirectional slots M4 x 8 (Quantity 2 pcs) **1147463**

Safety switch with separate actuator

Actuator AZ 17-B25

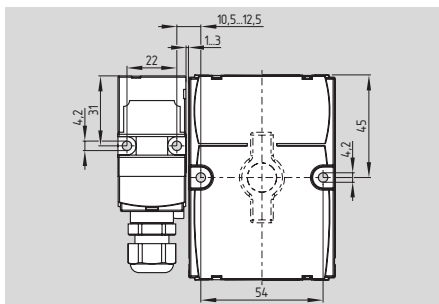

- Door-handle actuator for safety switches with separate actuator AZ 17-...zrk (latching)
- Ergonomic operation
- No supplementary door-handle required
- No protruding actuator
- Simple mounting
- Several door-handles available
- Possibility to mount the own handles using a default square screw (8mm)
- Mounting plate for fitting to standard profiles optionally available

System components

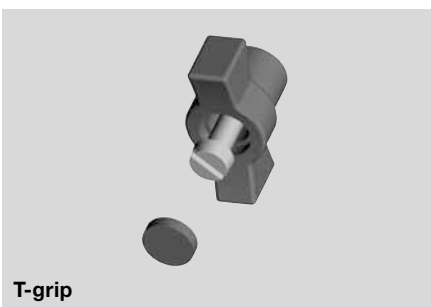
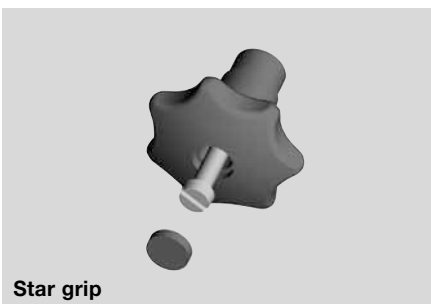
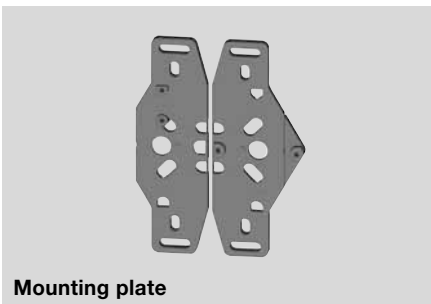

Note

The safety switch or solenoid interlock is not included in delivery and must be ordered separately.

Please note that you need a device with latching (r).

The technical data of the AZ 17-...zrk safety switch can be found in this main catalogue page 1-4 or in the online catalogue at www.products.schmersal.com.

Approvals



Ordering details

AZ 17-B25-①-②

No.	Replace	Description
①	L	Door hinge left
	R	Door hinge right (View directed towards the inside of the hazardous area)
②	G0	Actuator without handle
	G1	Star grip
	G2	T-grip

Ordering details

Mounting plate	MP AZ 17/170-B25
Star grip	G1
T-grip	G2

Safety switch with separate actuator

AZ 15

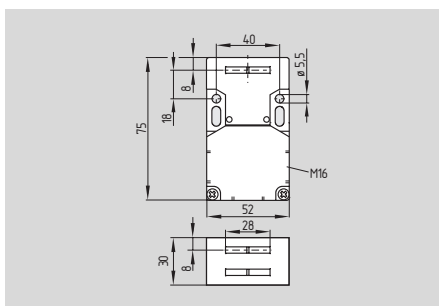

- Long life
- Multiple coding
- Thermoplastic enclosure
- Double insulated 
- 3 cable entries M16 x 1.5
- Large wiring compartment
- High level of contact reliability with low voltages and currents
- Not sensitive to dirty conditions by virtue of patented roller system
- Slotted holes for adjustment, circular holes for location

Technical data

Standards: IEC/EN 60947-5-1
BG-GS-ET-15

Enclosure: glass-fibre reinforced thermoplastic, self-extinguishing

Actuator: stainless steel 1.4301

Protection class: IP 67 to EN 60529

Contact material: silver

Contact type: 1 NC contact

Switching system: \ominus IEC 60947-5-1 slow action, NC contact with positive break

Connection: screw terminals

Cable section: max. 2.5 mm² (incl. conductor ferrules)

Cable entry: 3 x M16 x 1.5

U_{imp} : 6 kV

U_i : 500 V

I_{the} : 10 A

Utilisation category: AC-15, DC-13

I_e/U_e : 4 A / 230 VAC
4 A / 24 VDC

Max. fuse rating: 6 A gG D-fuse

Positive break travel: 8 mm

Positive break force: 10 N for each NC contact fitted

Ambient temperature: -30 °C ... +80 °C

Mechanical life: > 1 million operations

Latching force: 30 N for ordering suffix r

Contact variants

1 NC
11  12

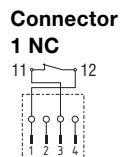

Approvals



Ordering details

AZ15-zv^①k-^②-^③

No.	Replace	Description
①	r	Ejection force Latching force 30 N
②	ST	Cable entry M 16 Connector M 12 x 1
③	2254	Latching force 5 N
	1762	Front mounting
	1637	Gold-plated contacts

Note

Actuators must be ordered separately.

Safety switch with separate actuator

AZ 16

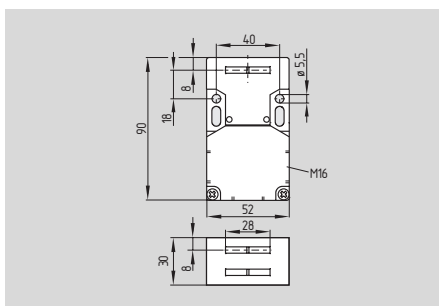

- Thermoplastic enclosure
- Multiple coding
- Individual coding available on request
- Long life
- Double insulated □
- 3 cable entries M16 x 1.5
- Large wiring compartment
- High level of contact reliability with low voltages and currents
- Not sensitive to dirty conditions by virtue of patented roller system
- Available with LED
- Slotted holes for adjustment, circular holes for location
- AS-Interface Safety at Work available, see chapter 5

Technical data

Standards: IEC/EN 60947-5-1
BG-GS-ET-15

Enclosure: glass-fibre reinforced thermoplastic, self-extinguishing

Actuator: stainless steel 1.4301

Protection class: IP 67 to EN 60529

Contact material: silver

Contact type: change-over contact with double break, type Zb or 2 NC or 3 NC contacts, with galvanically separated contact bridges

Switching system: ⊖ IEC 60947-5-1 slow action, NC contact with positive break

Connection: screw terminals

Cable section: max. 2.5 mm² (incl. conductor ferrules)

Cable entry: 3 x M16 x 1.5

U_{imp}: 6 kV

U_i: 500 V

I_{the}: 10 A

Utilisation category: AC-15, DC-13

I_e/U_e: 4 A / 230 VAC
4 A / 24 VDC

Max. fuse rating: 6 A gG D-fuse

Positive break travel: 8 mm

Positive break force: 10 N for each NC contact fitted

Ambient temperature: - 30 °C ... + 80 °C

Mechanical life: > 1 million operations

Latching force: 30 N for ordering suffix r

Contact variants

1 NO / 1 NC



2 NC



1 NO / 2 NC



3 NC



Connector

1 NO / 1 NC

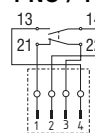

2 NC

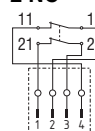

Approvals



Ordering details

AZ16-①zv②k-③-④-⑤

No.	Replace	Description
①		1 NO / 1 NC
	02	2 NC
	03	3 NC
	12	1 NO / 2 NC
②	r	Ejection force 30 N
		Latching force 30 N
③	G24	With LED
④		Cable entry M 16
	M20	Cable entry M 20
	ST	Connector M12 x 1 bottom
	STL	Connector M12 x 1 left
	STR	Connector M12 x 1 right
⑤	2254	Latching force 5 N
	1762	Front mounting
	1637	Gold-plated contacts

Note

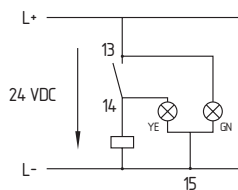

LED version:

Ordering suffix G24, only available for version with one NO and one NC contact. Protected against incorrect polarity and voltage spikes.

Note

Actuators must be ordered separately.

Safety switch with separate actuator

System components

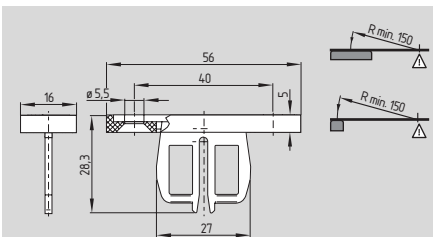

Straight actuator AZ 15/16-B1

System components

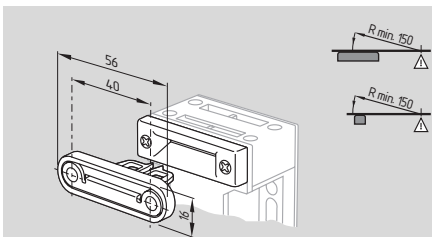

AZ 15/16-B1-2177 with centering guide

System components

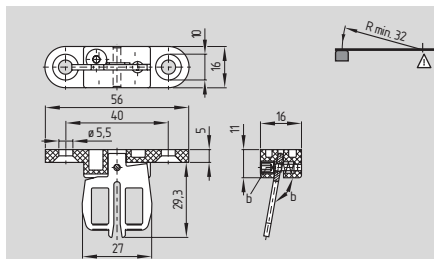

Flexible actuator AZ 15/16-B3

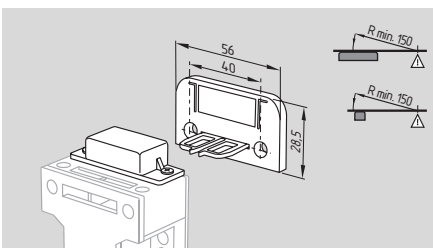

AZ 15/16-B1-1747 with magnetic latch

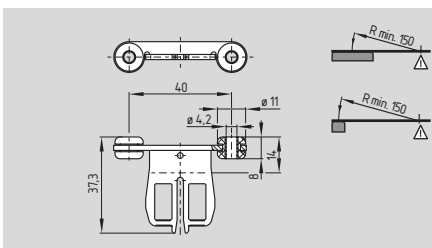

AZ 15/16-B1-2245 with rubber mounting

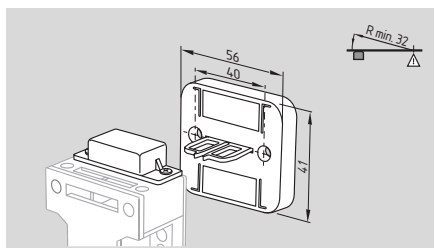

AZ 15/16-B3-1747 with magnetic latch

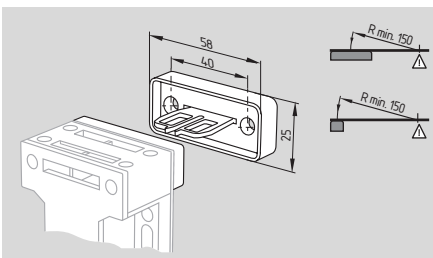

AZ 15/16-B1-2024 with slot lip-seal

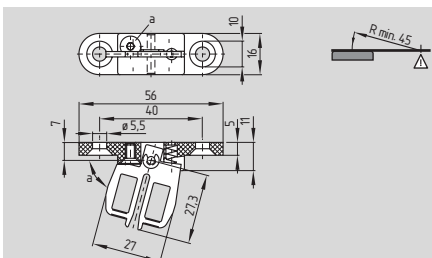

Flexible actuator AZ 15/16-B2

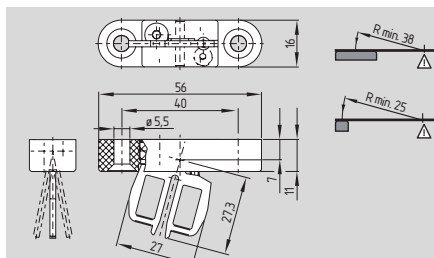

Flexible actuator AZ 15/16-B6

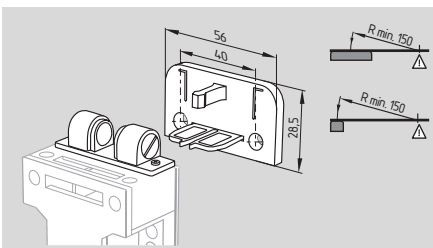

AZ 15/16-B1-2053 with ball latch

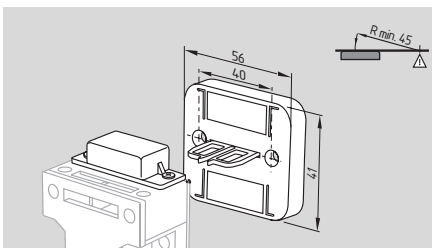

AZ 15/16-B2-1747 with magnetic latch

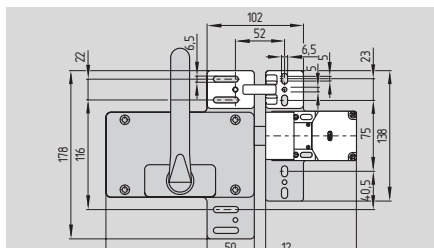

Actuator AZ 16-B30

Ordering details

Straight actuator
with magnetic latch
with slot lip-seal
with ball latch

AZ 15/16-B1
AZ 15/16-B1-1747
AZ 15/16-B1-2024
AZ 15/16-B1-2053

Straight actuator
with centering guide
with rubber mounting
Flexible actuator
with magnetic latch

AZ 15/16-B1-2177
AZ 15/16-B1-2245
AZ 15/16-B2
AZ 15/16-B2-1747

Ordering details

Flexible actuator
with magnetic latch
Flexible actuator

AZ 15/16-B3
AZ 15/16-B3-1747
AZ 15/16-B6

Actuator with or without
emergency handle

AZ 16-B30

A detailed product description can
be found in the „Safety door handle
system STS“ brochure.

Safety switch with separate actuator

System components

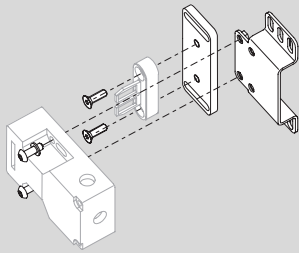

Mounting set MS AZ 15/16

System components

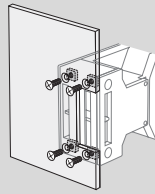

Front mounting AZ 15/16 -1762

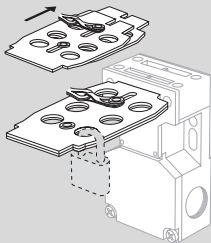

Lockout tag SZ 16/335



Connector plug M 12 x 1

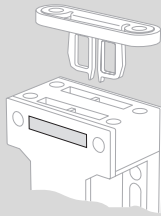

Slot sealing plug AZ 15/16-1476



Connector plug M 12 x 1 (with cable)

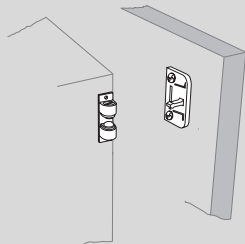

Ball catch 2053-2



Tamperproof screws

Ordering details

Mounting set **MS AZ 15/16**
 Lockout tag **SZ 16/335**
 Slot sealing plug **AZ 15/16-1476**
 Ball catch **-2053-2**

Ordering details

Front mounting with M5 nuts **-1762**
 Connector plug M 12 x 1 **1093038**
 Connector plug M 12 x 1 (with cable) **1148412**
 Tamperproof screws with unidirectional slots
 M5 x 12 **1135338**
 M5 x 16 **1135339**
 M5 x 20 **1135340**
 (Quantity 2 pcs)

Safety switch with separate actuator

AZ 335

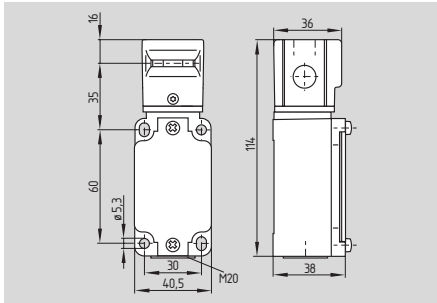

- Metal enclosure
- Up to 3 contacts
- Multiple coding
- Long life
- High level of contact reliability with low voltages and currents
- Mounting details to EN 50041
- Actuator heads can be repositioned in steps 4 x 90°
- Can be mounted on a flat surface
- Slotted holes for adjustment, circular holes for location
- Available with LED

Technical data

Standards: IEC/EN 60947-5-1
BG-GS-ET-15

Enclosure: light-alloy diecast, paint finish

Actuator: stainless steel 1.4301

Protection class: IP 67 to EN 60529

Contact material: silver

Contact type: change-over contact with double break, type Zb or 2 NC or 3 NC contacts, with galvanically separated contact bridges

Switching system: \ominus IEC 60947-5-1 slow action, NC contact with positive break

Connection: screw terminals

Cable section: max. 1.5 mm², min. 0.75 mm² (incl. conductor ferrules)

Cable entry: 1 x M20 x 1.5

U_{imp}: 2 contacts: 6 kV
3 contacts: 4 kV

U_i: connector: 0,8 kV
2 contacts: 500 V
3 contacts: 250 V
connector: 50 V

I_{the}: 10 A

Utilisation category: AC-15

I_e/U_e: 2 contacts: 4 A / 230 V
3 contacts: 4 A / 230 V
connector: 4 A / 50 V

Max. fuse rating: 6 A gG D-fuse

Positive break travel: 10.7 mm

Positive break force: 5 N for each NC contact fitted

Ambient temperature: -30 °C ... +90 °C

Mechanical life: 10 million operations

Latching force: 30 N for ordering suffix r

Contact variants

1 NO / 1 NC

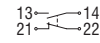

2 NC

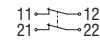

1 NO / 2 NC

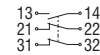

3 NC

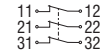

Connector

1 NO / 1 NC

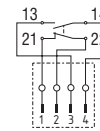

2 NC

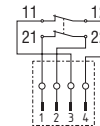

Approvals



Ordering details

AZ 335-①-z②k-③-④-⑤

No.	Replace	Description
①	11	1 NO / 1 NC
	02	2 NC
	03	3 NC
	12	1 NO / 2 NC
②	r	Latching force 5 N
	ü	Latching force 30 N
		With overlapping contacts
③	G24	With LED
④	NPT	Cable entry M 20
	ST	Cable entry NPT 1/2"
⑤	1637	Connector M 12 x 1
		Gold-plated contacts

Actuators must be ordered separately.

SCHMERSAL

Note

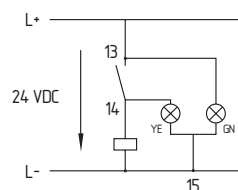

LED version:

Ordering suffix G24, only available for version with one NO and one NC contact. Protected against incorrect polarity and voltage spikes.

Caution! The versions with connector may only be used in PELV circuits to EN 60204-1.

Note

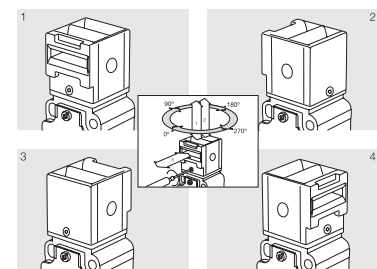

By turning the head in 90° steps, 8 actuating planes are possible. A Torx T10 screwdriver is needed for this purpose.

Even when the screw is removed, the head is self-retaining. The switch can still not be tampered.

Safety switch with separate actuator

AZ 355

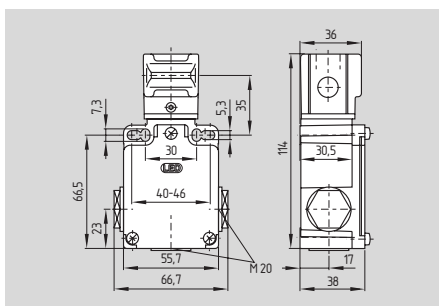

- Metal enclosure
- Up to 3 contacts
- Multiple coding
- Long life
- High level of contact reliability with low voltages and currents
- Mounting details to EN 50041
- 3 cable entries
- Actuator heads can be repositioned in steps 4 x 90°
- Can be mounted on a flat surface
- Transverse and longitudinal slotted holes
- Available with LED

Technical data

Standards: IEC/EN 60947-5-1
BG-GS-ET-15

Enclosure: light-alloy diecast, paint finish

Actuator: stainless steel 1.4301

Protection class: IP 67 to EN 60529

Contact material: silver

Contact type: change-over contact with double break, type Zb or 2 NC or 3 NC contacts, with galvanically separated contact bridges

Switching system: \ominus IEC 60947-5-1 slow action, NC contact with positive break

Connection: screw terminals

Cable section: max. 1.5 mm², min. 0.75 mm² (incl. conductor ferrules)

Cable entry: 3 x M20 x 1.5

U_{imp}: 2 contacts: 6 kV
3 contacts: 4 kV

U_i: connector: 0,8 kV
2 contacts: 500 V
3 contacts: 250 V

connector: 50 V

I_{the}: 10 A

Utilisation category: AC-15

I_e/U_e: 2 contacts: 4 A / 230 V
3 contacts: 4 A / 230 V

connector: 4 A / 50 V

Max. fuse rating: 6 A gG D-fuse

Positive break travel: 10.7 mm

Positive break force: 5 N for each NC contact fitted

Ambient temperature: -30 °C ... +90 °C

Mechanical life: 10 million operations

Latching force: 30 N for ordering suffix r

Contact variants

1 NO / 1 NC



2 NC



1 NO / 2 NC



3 NC



Connector

1 NO / 1 NC

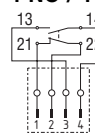

2 NC

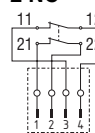

Approvals



Ordering details

AZ 355-①-z②k-③-④-⑤

No.	Replace	Description
①	11	1 NO / 1 NC
	02	2 NC
	03	3 NC
	12	1 NO / 2 NC
②	r	Latching force 5 N
	ü	Latching force 30 N
		With overlapping contacts
③	G24	With LED
④		Cable entry M 20
	NPT	Cable entry NPT 1/2"
	ST	Connector M 12 x 1
⑤	1637	Gold-plated contacts

Actuators must be ordered separately.

Note

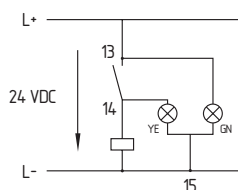

LED version:

Ordering suffix G24, only available for version with one NO and one NC contact. Protected against incorrect polarity and voltage spikes.

Caution! The versions with connector may only be used in PELV circuits to EN 60204-1.

Note

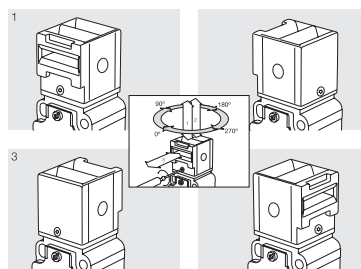

By turning the head in 90° steps, 8 actuating planes are possible. A Torx T10 screwdriver is needed for this purpose.

Even when the screw is removed, the head is self-retaining. The switch can still not be tampered.

Safety switch with separate actuator

System components

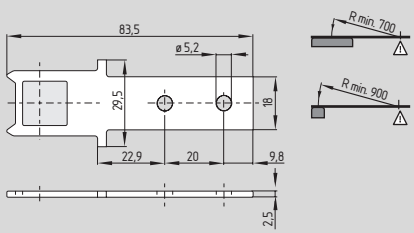

Straight actuator AZ 335/355-B1

System components

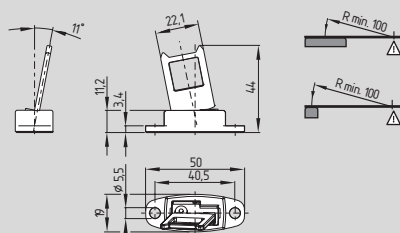

Flexible actuator AZ 335/355-B6

System components

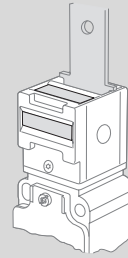

Slot sealing plug AZ 335/355-1990

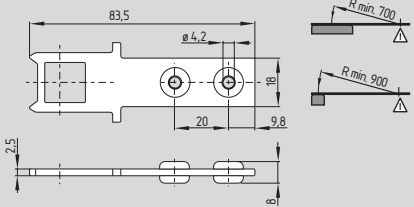

AZ 335/355-B1-2245 with rubber mounting

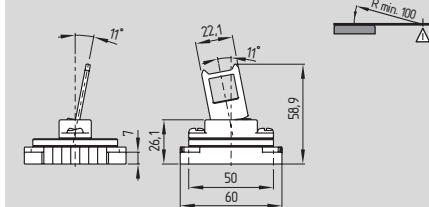

Flexible actuator AZ 335/355-B6-Flex

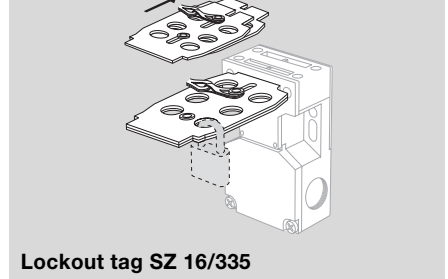

Lockout tag SZ 16/335

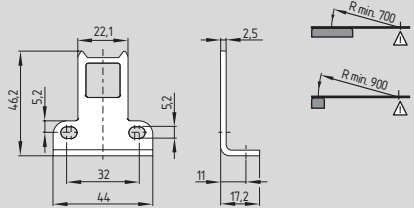

Angled actuator AZ 335/355-B5

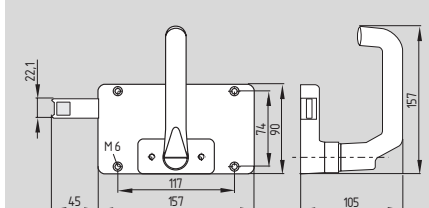

Actuator AZ 335/355-B30

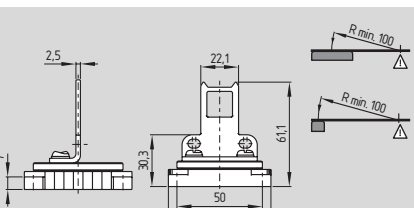

Angled actuator AZ 335/355-B5-Flex

Ordering details

Straight actuator **AZ 335/355-B1**
 with rubber mounting **AZ 335/355-B1-2245**
 Angled actuator **AZ 335/355-B5**
 Angled actuator **AZ 335/355-B5-Flex**

Ordering details

Flexible actuator **AZ 335/355-B6**
 Flexible actuator **AZ 335/355-B6-Flex**
 Actuator with or without
 emergency handle **AZ 335/355-B30**

Ordering details

Slot sealing plug **AZ 335/355-1990**
 Lockout tag **SZ 16/335**

A detailed product description can be found in the „Safety door handle system STS“ brochure.

Safety switch with separate actuator

AZ 415

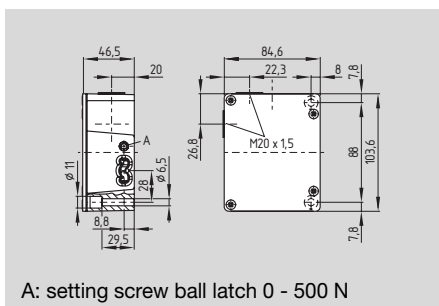

A: setting screw ball latch 0 - 500 N

- Metal enclosure
- 2 switches with different actuating functions in a single enclosure
- Long life
- High level of contact reliability with low voltages and currents
- 2 cable entries M20 x 1.5
- Adjustable ball latch to 500 N
- Spring-loaded actuators

Technical data

Standards: IEC/EN 60947-5-1 BG-GS-ET-15
 Enclosure: light-alloy diecast, paint finish
 Actuator: zinc-plated brass/aluminium
 Protection class: IP 67 to EN 60529
 Contact material: silver
 Contact type: change-over contact with double break, type Zb or 2 NC contacts, with galvanically separated contact bridges
 Switching system: \ominus IEC 60947-5-1 slow action,

NC contact with positive break
 Connection: screw terminals
 Cable section: max. 1.5 mm², min. 0.75 mm² (incl. conductor ferrules)

Cable entry: 2 x M20 x 1.5
 U_{imp}: 4 kV
 U_i: 250 V
 I_{the}: 6 A
 Utilisation category: AC-15
 I_e/U_e: 4 A / 230 VAC
 Max. fuse rating: 6 A gG D-fuse
 Positive break travel: 3.8 mm
 Positive break force: min. 31 N
 Ambient temperature: - 25 °C ... + 70 °C
 Mechanical life: > 1 million operations
 Latching force: 0 - 500 N (adjustable)

Contact variants

1 NO / 1 NC
 1 NO / 1 NC

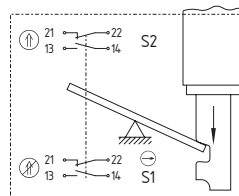

2 NC
 1 NO / 1 NC

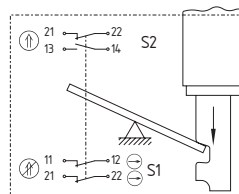

2 NO
 2 NC

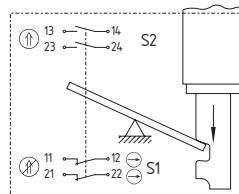

2 NC
 2 NC

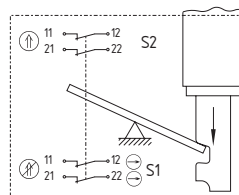

Approvals



Ordering details

AZ 415-①zpk-②

No.	Replace	Description
①	02/11	2NC / 1NO 1NC
	02/02	2NC / 2NC
	02/20	2NC / 2NO
	11/11	1NO 1NC / 1NO 1NC
②	1637	Gold-plated contacts

Note

Actuators must be ordered separately.

Note

Contact symbols shown for the closed condition of the guard device.

Safety switch with separate actuator

AZ 415-33

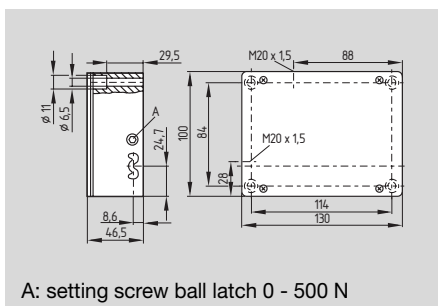

A: setting screw ball latch 0 - 500 N

- Metal enclosure
- 3 switches with different actuating functions in one enclosure
- Long life
- High level of contact reliability with low voltages and currents
- 2 cable entries M20 x 1.5
- Adjustable ball latch to 500 N
- Spring-loaded actuators

Technical data

Standards: IEC/EN 60947-5-1
BG-GS-ET-15

Enclosure: light-alloy diecast, paint finish
Actuator: zinc-plated brass/aluminium

Protection class: IP 67 to EN 60529

Contact material: silver

Contact type: change-over contact with double break, type Zb, with galvanically separated contact bridges

Switching system: IEC 60947-5-1
slow action,
NC contact with positive break

Connection: screw terminals

Cable section: max. 2.5 mm²
(incl. conductor ferrules)

Cable entry: 2 x M20 x 1.5

U_{imp}: 4 kV

U_i: 250 V

I_{the}: 6 A

Utilisation category: AC-15

I_e/U_e: 4 A / 230 VAC

Max. fuse rating: 6 A gG D-fuse

Positive break travel: 5.5 mm

Positive break force: min. 15 N

Ambient temperature: - 25 °C ... + 80 °C

Mechanical life: > 1 million operations

Latching force: 0 - 500 N (adjustable)

Contact variants

3 NO

3 NC

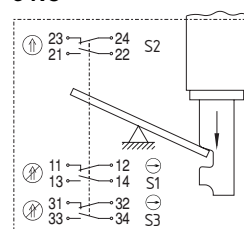

Approvals



Ordering details

AZ 415-33zk-①

No.	Replace	Description
①	1637	Gold-plated contacts

Note

Actuators must be ordered separately.

Note

Contact symbols shown for the closed condition of the guard device.

Safety switch with separate actuator

AZ 415-33 for double doors

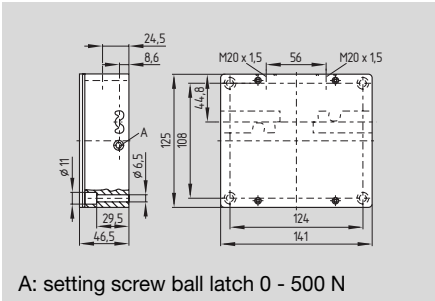

- Metal enclosure
- 3 switches with different actuating functions in one enclosure
- for double doors
- Long life
- High level of contact reliability with low voltages and currents
- 2 cable entries M20 x 1.5
- Ball latch for each door, individually adjustable up to 500 N
- Spring-loaded actuators

Technical data

Standards: IEC/EN 60947-5-1
BG-GS-ET-15

Enclosure: light-alloy diecast, paint finish

Actuator: zinc-plated brass/aluminium

Protection class: IP 67 to EN 60529

Contact material: silver

Contact type: change-over contact with double break, type Zb, with galvanically separated contact bridges

Switching system: \ominus IEC 60947-5-1
slow action,
NC contact with positive break

Connection: screw terminals

Cable section: max. 2.5 mm²
(incl. conductor ferrules)

Cable entry: 2 x M20 x 1.5

U_{imp} : 4 kV

U_i : 250 V

I_{the} : 6 A

Utilisation category: AC-15

I_e/U_e : 4 A / 230 VAC

Max. fuse rating: 6 A gG D-fuse

Positive break travel: 5.5 mm

Positive break force: min. 15 N

Ambient temperature: - 25 °C ... + 80 °C

Mechanical life: > 1 million operations

Latching force: 0 - 500 N (adjustable)

Contact variants

3 NO
3 NC

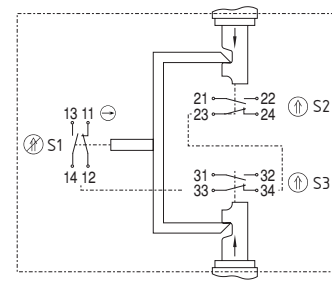

Approvals



Ordering details

AZ 415-33zpdk-①

No.	Replace	Description
①	1637	Gold-plated contacts

Note

Actuators must be ordered separately.

Note

Contact symbols shown for the closed condition of the guard device.

Safety switch with separate actuator

System components

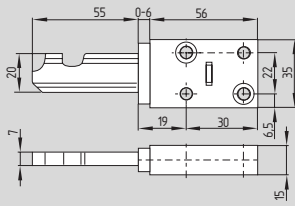

Straight actuator AZ/AZM 415-B1

System components

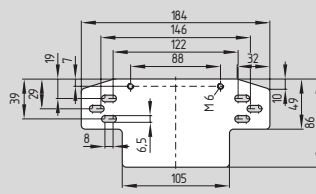

Mounting plate MP AZ 415-22

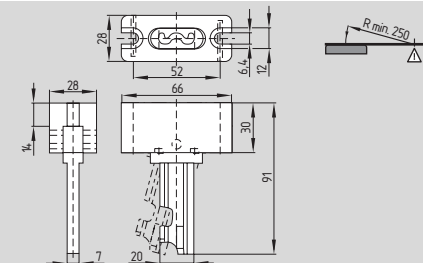

Flexible actuator AZ/AZM 415-B2

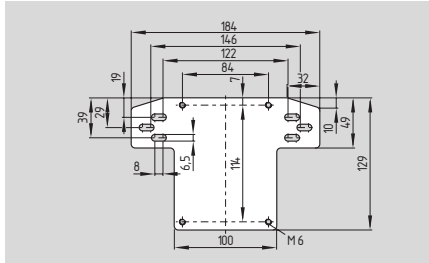

Mounting plate MP AZM 415-22

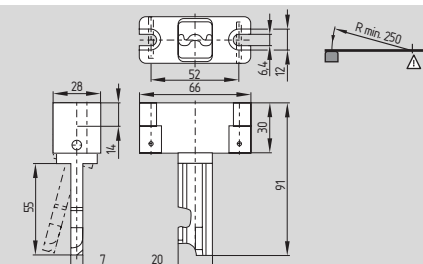

Flexible actuator AZ/AZM 415-B3

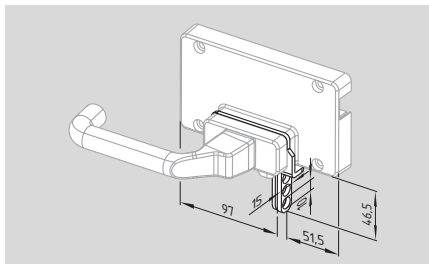

Lockout tag SZ 415-1/-2

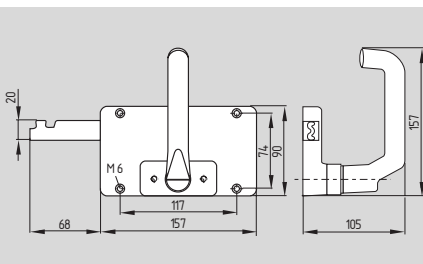

Actuator AZ/AZM 415-B30

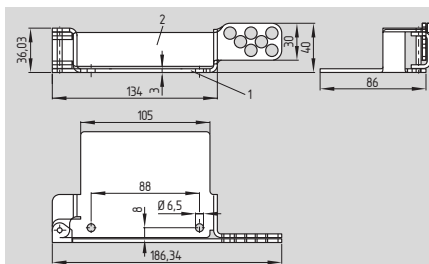

Lockout tag SZ 415-22-1/-2

Ordering details

Straight actuator **AZ/AZM 415-B1**
 Flexible actuator **AZ/AZM 415-B2**
 Flexible actuator **AZ/AZM 415-B3**

Actuator with or without emergency handle **AZ/AZM 415-B30**

A detailed product description can be found in the „Safety door handle system STS“ brochure.

Ordering details

Mounting plate **MP AZ 415-22**
 Mounting plate **MP AZM 415-22**
 Lockout tag **SZ 415-1/-2**
 Lockout tag **SZ 415-22-1/-2**